

REARSIGHT CAMERA SYSTEM

250-8052

INSTALLATION INSTRUCTIONS

CONTENTS

PARTS IDENTIFICATION	2
SYSTEM LAYOUT	3
INSTALLATION	4
TESTING	10
REASSEMBLY	10
INSTALLATION TIPS	10
MENU FUNCTIONS	11

PARTS IDENTIFICATION

ITEM	QUANTITY	PART NUMBER	DESCRIPTION
1	1	2508203	REARSIGHT MONITOR
	1		MONITOR EXTENSION HARNESS
	1		MONITOR STAND (not shown)
	1	FORM # 5165	INSTALLATION MANUAL (not shown)
2	1	2508110	REAR CAMERA ASSEMBLY
3	1	2508530	CAMERA RCA & POWER HARNESS
4	1	2508511	CAMERA A/V EXTENSION HARNESS
5	1	2508509	SACK PARTS: TIE STRAPS, T-TAPS, SEALING PUTTY



SYSTEM LAYOUT

DIAGRAM A

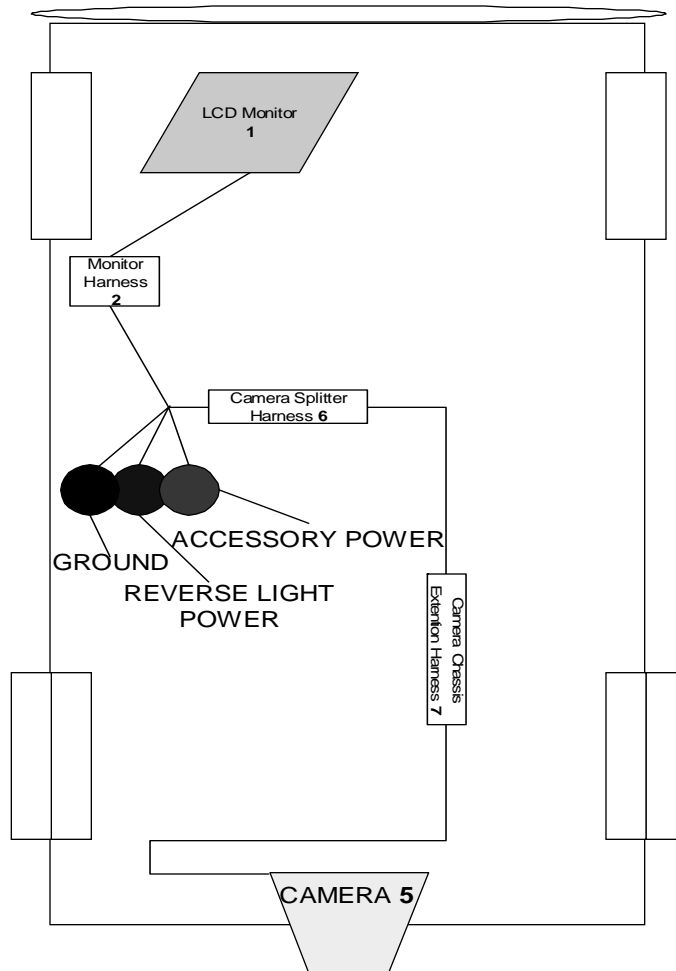

VEHICLE PREPARATION

Before beginning installation, familiarize yourself with the installation instructions and the REAR SIGHT camera system components.

To ensure your safety:

- A) Apply the emergency brake.
- B) Read this manual before starting.

CAUTION: It is advisable to disconnect the negative battery cable for 3 minutes before beginning installation, to avoid unintended air bag deployment. Note and record any anti-theft radio codes prior to disconnecting.

INSTALLATION

STEP 1: HARNESS CONNECTIONS

1. ROUTE HARNESSES TO BE JOINED WITH VIDEO 2 (VIDEO 2 ALLOWS REVERSE OVERRIDE TO FUNCTION) RCA, AUDIO RCA & DC POWER CONNECTOR HARNESS AS PER DIAGRAM. USE PROVIDED WIRE TIES TO SECURE WIRING HARNESS AWAY FROM MOVING PARTS AND SHARP EDGES.

CONNECTIONS

- RCA **BLUE** VIDEO 2 HARNESS TO RCA **RED** CAMERA HARNESS 250-8530
- RCA **WHITE** AUDIO VIDEO HARNESS TO RCA **WHITE** AUDIO CAMERA HARNESS 250-8530
- VIDEO 1 (YELLOW) RCA HARNESS AND AUDIO (RED) NOT USED IN THIS KIT. (NOTE THIS INPUT CAN BE USED FOR SECOND CAMERA, NAVIGATION...ANY RCA DISPLAY)
- RED **BAT** AND YELLOW **ACC** WIRES FROM MONITOR HARNESS TO IGNITION 12V POWER.
- DC POWER FROM 250-8530 IS NOT USED.
- BLACK **GROUND** WIRE (LOCATED ON 250-8530 CAMERA RCA & POWER HARNESS) AND FROM MONITOR HARNESS – TO CHASSIS GROUND
- RED/BLACK **IGNITION** WIRE (LOCATED ON 250-8530 CAMERA RCA & POWER HARNESS) – TO IGNITION 12V POWER
- GREEN **BACK** MONITOR HARNESS TO REVERSE 12V POWER

WIRING DIAGRAM

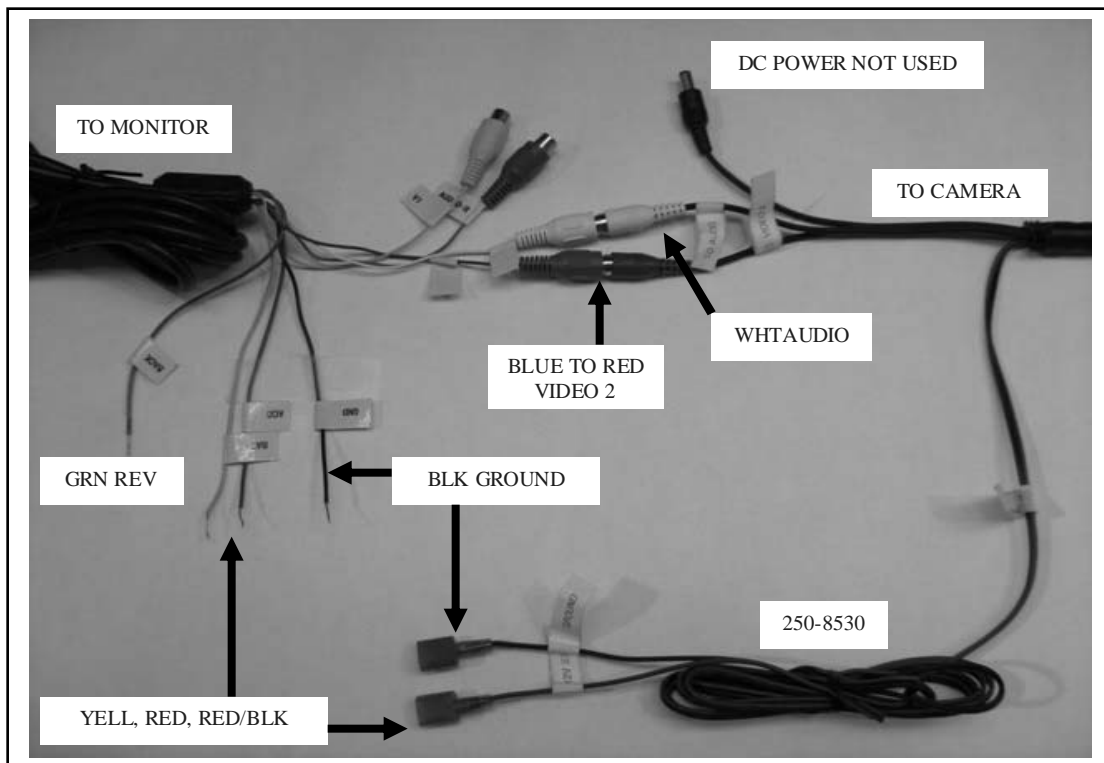

INSTALLATION

STEP 2: MOUNTING MONITOR



1. BEGIN MONITOR INSTALLATION BY FORMING MONITOR BASE TABS TO FIT THE CONTOUR OF THE DASH WHERE MONITOR IS TO BE PLACED. BY FAILING TO PROPERLY FORM THE BASE TABS, THE BASE WILL NOT ADHERE SECURELY TO THE DASH
2. ONCE DRY FITMENT TO THE DASH IS COMPLETE ATTACH THE MONITOR TO THE BASE TO VERIFY PLACEMENT AND SECURITY OF FASTENERS ASSOCIATED WITH FIXING MONITOR POSITION ON THE BASE. YOU MUST SECURE MONITOR IN POSITION DESIRED. THIS WILL INSURE THAT MONITOR STAYS IN POSITION DESIRED ONCE INSTALLATION IS COMPLETE. WARNING: CENTER BOTTOM BOLT IS NOT ADJUSTABLE AFTER MOUNTING/STICKING BASE TO DASH WITH ADHESIVE STRIP!

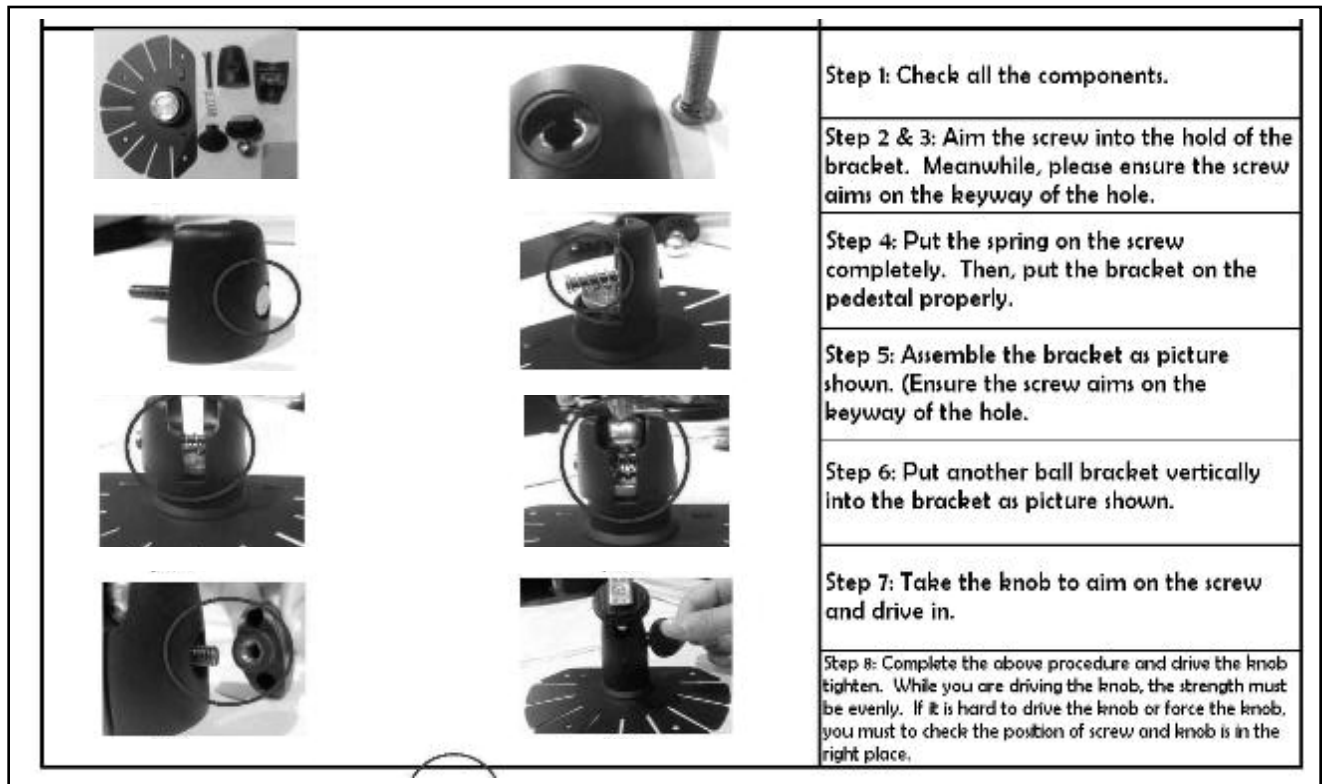

3. USE AN ALCOHOL PAD TO CLEAN THE DASH AREA AND BASE OF PEDESTAL SELECTED FOR INSTALLATION. (IN THE EVENT THE DASH HAS BEEN WIPED WITH A SILICON PRODUCT AN ACTIVATOR MAY BE REQUIRED TO REMOVE THE EFFECTS OF THE SILICON MATERIAL.)

4. ONCE THE BASE HAS BEEN CLEANED AND DRIED, REMOVE ADHESIVE COVER FROM ONE SIDE OF MONITOR BASE ADHESIVE MOUNTING FOAM AND APPLY IT TO THE MONITOR BASE. WARNING: THE FOAM ADHESIVE IS A ONE TIME STICK PRODUCT. IF YOU PLACE IMPROPERLY YOU WILL HAVE TO REPLACE THE FOAM AND THERE IS ONLY ONE STRIP WITH THE KIT. WITH THE FOAM ADHESIVE STRIP AND THE DASH CLEANED AND DRIED, REMOVE THE ADHESIVE COVER FROM THE MONITOR BASE. PLACE THE MONITOR IN POSITION AND PRESS FIRMLY IN PLACE FOR 20-30 SECONDS TO ENSURE SOLID ADHESION. (FIGURE 3)

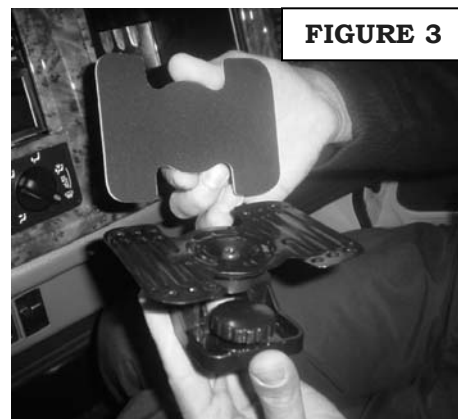
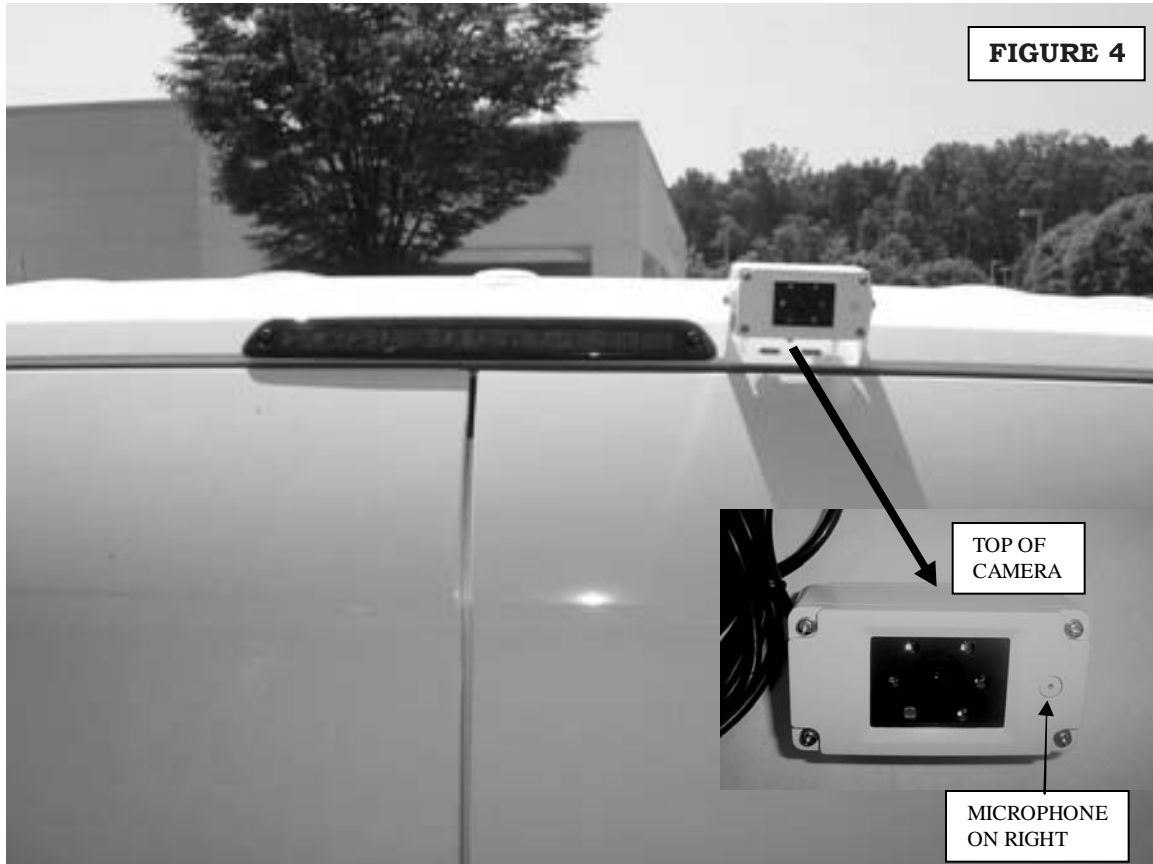

FIGURE 3

INSTALLATION

STEP 3: MOUNTING CAMERA



1. WHEN MOUNTING THE CAMERA CHOOSE A LOCATION THAT MEETS SOME VERY IMPORTANT REQUIREMENTS.
 - CAMERA IS MOUNTED IN MANNER THAT PROVIDES A CLEAR VIEW FOR THE BACK OF THE VEHICLE. THIS VIEW SHOULD INCLUDE A PORTION OF THE VEHICLE AS TO PROVIDE A POINT OF REFERENCE. THIS WILL LET YOU UNDERSTAND HOW FAR AWAY YOU ARE FROM AN OBJECT AND THE RATE OF CLOSER TO IT. ALSO CONSIDER BLINDSPOT AREAS.
 - THE CAMERA SHOULD BE IN AN AREA OF THE VEHICLE THAT PROTECTS IT FROM OBVIOUS DAMAGE DUE TO FREIGHT DELIVERY OR GENERAL VEHICLE USE. (FREE OF DOORS, DUMP BED TRAVEL...AWNINGS ON BUILDINGS...ETC)
 - WHENEVER POSSIBLE AVOID INSTALLING CAMERA IN LOW OR EXPOSED PLACES WHERE LENS CAN BE COVERED WITH ROAD DIRT, MUD AND EXHAUST GASES.

- USE BRACKET FOR TEMPLATE TO MOUNT CAMERA AT OUTERMOST POINT OF FRAME.
- ASSEMBLE CAMERA AS SHOWN. ANGLE CAMERA FULLY TO THE GROUND IN ORDER TO SEE BUMPER OF TRUCK.

FIGURE 5



2. ALWAYS UTILIZE STANDARD PRACTICE OF VEHICLE WIRE ROUTING WHEN ROUTING CABLES. THIS INCLUDES ROUTING LOCATION, ATTACHMENT AND TIE POINTS.

- ROLLING DOOR SPRING WILL RUB THROUGH INSULATION AND DAMAGE CAMERA. ALWAYS ATTACH TO CLEARANCE LIGHTS MAIN TIE POINTS AND ALSO TO EXISTING HARNESS. (FIGURE 6)

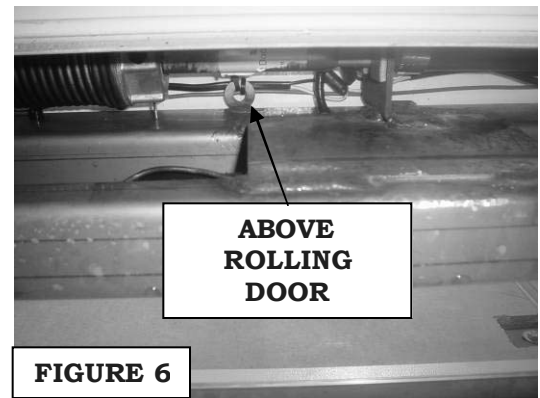

- ROUTE CABLES INSIDE WALL OF TRUCK BODY TO PREVENT ANY DAMAGE TO CIRCUITS. (FIGURE 7)

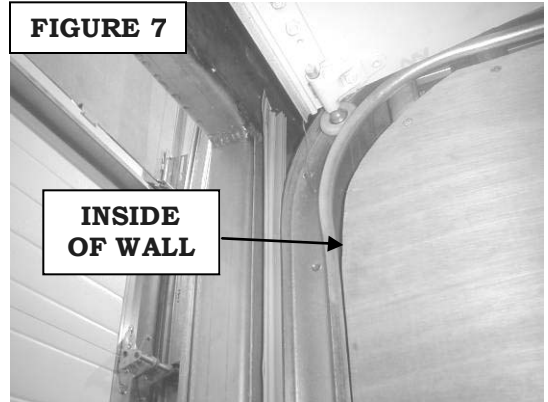

- ROUTE WITH EXISTING CABLES AT EXITS AT THE BOTTOM OF THE BOX AND ALONG FRAME RAIL WIRE TIE CIRCUITS AT A MINIMUM AT THE OEM FREQUENCY. (FIGURE 8)

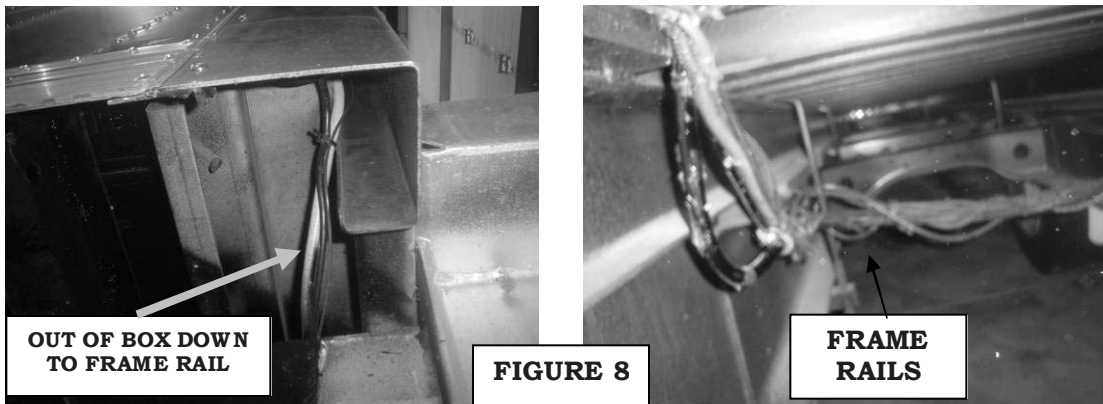

3. OPTIONAL INSTALLATIONS



TESTING AND REASSEMBLY

TESTING

1. RECONNECT NEGATIVE BATTERY CABLE AND TORQUE TO **3 FT*LBS**. RE-ENTER ANY THEFT DETERRENT INFORMATION, IF APPLICABLE.
2. TURN THE IGNITION SWITCH **ON**. PRESS THE **MENU** BUTTON TO SWITCH FROM VIDEO 1 TO VIDEO2. VERIFY THAT THE REARSIGHT MONITOR IS ON AND THE CAMERA'S PICTURE APPEARS. PRESS THE POWER BUTTON. PUT THE VEHICLE IN REVERSE. VERIFY THAT THE CAMERA'S PICTURE APPEARS.
3. IF THERE IS NO PICTURE, VERIFY ALL CONNECTIONS ARE SECURE.

REASSEMBLY

1. REINSTALL ALL TRIM PIECES TAKING SPECIAL CARE TO ENSURE HARNESSSES AND WIRING CONNECTIONS ARE PROPERLY SECURED.
2. BE SURE HARNESS IS NOT PINCHED OR BOUND BY TRIM PIECES.
3. PLACE THE OWNER'S CARD IN THE GLOVE BOX.
4. RECONNECT ALL DISCONNECTED BULBS AND CHECK FOR FUNCTION.

INSTALLATION TIPS

- **CONFIRM PROPER CABLE EXTENTION CONNECTOR ORIENTATION AND ALWAYS VERIFY PROPER ENDS ARE ROUTED IN PROPER DIRECTION.**
- **IT IS A GOOD IDEA TO DRY FIT THE KIT BEFORE PERMANENTLY ATTACHING THE UNIT TO INSURE PROPER ORIENTATION AND OPERATION BEFORE BEGINNING INSTALLATION FOR FAMILIARIZATION OF COMPONENTS.**
- **READ ALL INSTRUCTIONS AND WARNINGS BEFORE BEGINNING THE INSTALLATION OF THIS KIT.**
- **ALWAYS TREAT ANY METAL EXPOSED DURING INSTALLATION WITH RUST PREVENTATIVE COMPOUND TO PREVENT RUST AND OR CORROSION FAILURE.**
- **ALWAYS SEAL ANY HOLES DRILLED WITH PROVIDED SEALING PUTTY TO PREVENT WATER INFILTRATION INTO UNPROTECTED OR AREAS OF CONCERN.**
- **CONFIRM INTEGRITY OF MECHANICAL AND ELECTRICAL CONNECTIONS BEFORE MOVING TO NEXT INSTALLATION SEQUENCE.**

MENU FUNCTIONS

Function		Function statement
Brightness	0~32	Press ▲ or ▼ adjust Brightness. 0~32
Contrast	0~32	Press ▲ or ▼ adjust Contrast. 0~32
Saturation	0~32	Press ▲ or ▼ adjust Saturation. 0~32
Hue	0~32	Press ▲ or ▼ adjust Hue. 0~32
Sharpness	0~32	Press ▲ or ▼ adjust Sharpness. 0~32
Reset		Press “ Reset ”, screen will Reset all setup
Next		Press “ Next ”, screen will Next page menu
Exit		Press “ Exit ”, screen will Exit setup function mode

Source	AV1	Press “ Source ” to select source AV1
	AV2	Press “ Source ” to select source AV2
Dimmer Set	AUTO	Press “ Dimmer Set ” to select Auto Dimmer (OPTION)
	D1	Press “ Dimmer Set ” to select Dimmer 1 setup
	D2	Press “ Dimmer Set ” to select Dimmer 2 setup
	OFF	Press “ Dimmer Set ” to select off Dimmer function
Dimmer 1	0~9	Press ▲ or ▼ adjust Dimmer 1 bright. 0~9
Dimmer 2	0~9	Press ▲ or ▼ adjust Dimmer 2 bright. 0~9
R/L	ON/OFF	Press ON or OFF adjust screen picture to reverse
Zoom	4:3 / 16:9	Press ▲ or ▼ select screen Mode 16:9 or 4:3
Next		Press “ Next ”, screen will to Next page menu
Exit		Press “ Exit ”, screen will Exit setup function mode

MENU FUNCTIONS

Mute Set	Mute	Press “ Mute Set ” to select audio mute
	Normal	Press “ Mute Set ” to select cancel audio mute
IR/TR	OFF	Press “ IR/TR ” to select Off wireless earpieces
	CH A	Press “ IR/TR ” to select A CH wireless earpieces
	CH B	Press “ IR/TR ” to select B CH wireless earpieces
ACC Set	ON/OFF	Press “ ACC Set ”, screen ACC can setup on or off
Next		Press “ Next ”, screen will to Next page menu
Exit		Press “ Exit ”, screen will Exit setup function mode

Function		Function statement
Distance 1	0~99	Press ▲ or ▼ adjust Distance 1. 0~99
Distance 2	0~99	Press ▲ or ▼ adjust Distance 2. 0~99
Distance 3	0~99	Press ▲ or ▼ adjust Distance 3. 0~99
Distance 4	0~99	Press ▲ or ▼ adjust Distance 4. 0~99
Unit	M	Press “ Unit ” to select metric system
	Ft	Press “ Unit ” to select EU system
CCD Set	ON/OFF	Press “ CCD Set ”, CCD function
Next		Press “ Next ”, screen will to Next page menu
Exit		Press “ Exit ”, screen will Exit setup function mode