

Rostra RearSight
250-8801-CCD
250-8802-CCD
250-8803-CCD
Installation Instructions



CONTENTS

PARTS IDENTIFICATION.....	2
HELPFUL HINTS.....	2
MONITOR INSTALLATIONS.....	3
CAMERA INSTALLATION.....	5
WIRING DIAGRAM & TESTING.....	6
MOUNTING TEMPLATES.....	7

PARTS IDENTIFICATION

ITEM	QUANTITY	PART NUMBER	DESCRIPTION
1	1	250-8801	3.5 REARSIGHT MONITOR/MIRROR/COMP,TEMP
	1	250-8802	3.5 REARSIGHT MONITOR/MIRROR/ONSTAR
2	1	250-8803	3.5 MONITOR INTERFACE HARNESS/ONSTAR,COMP,TEMP
	1	250-8067	3.5 MONITOR INTERFACE HARNESS
3	1	250-8550	CAMERA EXTENSION HARNESS
4	1	250-8112	REAR CAMERA ASSEMBLY
5	1	250-8567	SACK PARTS: TIE STRAPS, T-TAPS, SEALING PUTTY



HELPFUL HINTS

- 1. BEFORE STARTING INSTALLATION:**
FAMILIARIZE YOURSELF WITH THE INSTALLATION INSTRUCTIONS AND REARSIGHT COMPONENTS.
- 2. ANTI-THEFT RADIO:**
IF VEHICLE IS EQUIPPED WITH AN ANTI-THEFT RADIO, THE RADIO CODE MUST BE WRITTEN DOWN PRIOR TO DISCONNECTING BATTERY CABLE. THE CODE MUST BE REENTERED WHEN THE NEGATIVE BATTERY CABLE IS REINSTALLED.
- 3. REMOVAL OF NEGATIVE BATTERY CABLE:**
DISCONNECT THE **NEGATIVE BATTERY CABLE** FOR **THREE MINUTES** BEFORE INSTALLING THE REARSIGHT COMPONENTS TO AVOID UNINTENDED AIRBAG DEPLOYMENT.

FIGURE 1

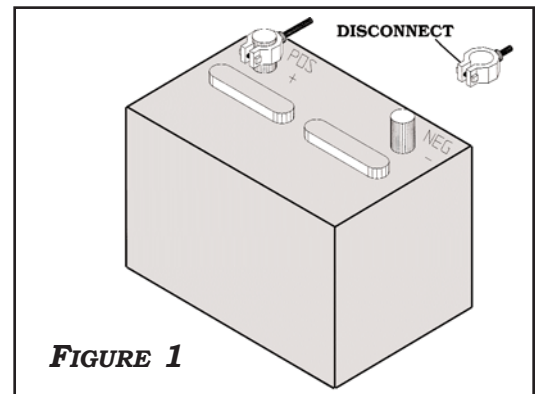
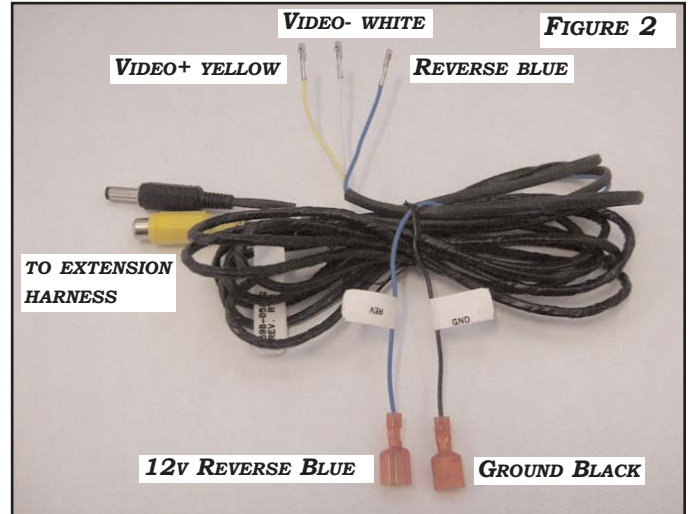

FIGURE 1

MONITOR INSTALLATIONS

1. REMOVE THE FACTORY MIRROR FROM VEHICLE. USE THE MIRROR MONITOR INTERFACE HARNESS PROVIDED IN KIT TO CONNECT TO THE FACTORY MIRROR CONNECTOR. RELEASE THE RETAINER OF THE VEHICLE CONNECTOR AS SHOWN TO INSERT EACH TERMINAL USING **FIGURE 2** WITH THE MONITOR PIN-OUT LISTINGS BELOW. CONNECT THE MIRROR MONITOR INTERFACE HARNESS TO EXTENSION HARNESS.



NOTE: IF REVERSE WIRE IS PRESENT IN VEHICLE CONNECTOR, REVERSE WIRES ARE NOT NEEDED FOR THIS APPLICATION

250-8801

PIN	CIRCUIT DESCRIPTION
1	CAMERA NTSC/PAL VIDEO (+)
2	CAMERA NTSC/PAL VIDEO (-)
3	CAMERA VIDEO SHIELD
4	NOT USED
5	SINGLE OUTSIDE DRIVE EC (+)
6	OUTSIDE TEMPERATURE (+)
7	OUTSIDE TEMPERATURE (-)
8	VEHICLE GROUND
9	REVERSE INPUT (ACTIVE HIGH)
10	NOT USED
11	NOT USED
12	NOT USED
13	IGNITION (RUN ONLY LINE)
14	NOT USED
15	NOT USED
16	SINGLE OUTSIDE DRIVE EC (-)

250-8802

PIN	CIRCUIT DESCRIPTION
1	NOT USED
2	NOT USED
3	NOT USED
4	NOT USED
5	SINGLE OUTSIDE DRIVE EC (+)
6	CAMERA VIDEO SIGNAL (+)
7	CAMERA VIDEO SIGNAL (-)
8	VEHICLE GROUND
9	REVERSE INPUT (ACTIVE HIGH)
10	NOT USED
11	ONSTAR KEYPAD OUTPUT
12	ONSTAR KEYPAD POWER
13	IGNITION (RUN ONLY LINE)
14	ONSTAR LED GREEN
15	ONSTAR LED RED
16	SINGLE OUTSIDE DRIVE (-)

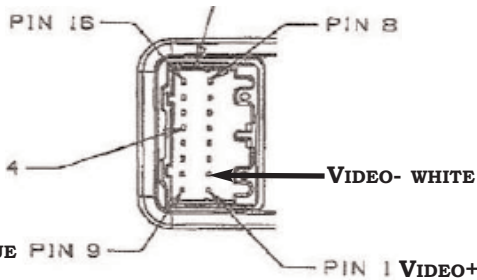

REVERSE BLUE PIN 9

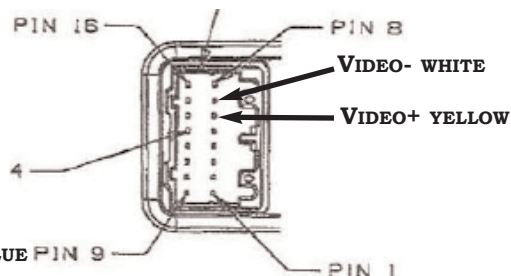

REVERSE BLUE PIN 9

MONITOR INSTALLATIONS

250-8803

PIN	CIRCUIT DESCRIPTION
1	CAMERA NTSC/PAL VIDEO (+)
2	CAMERA NTSC/PAL VIDEO (-)
3	CAMERA VIDEO SHIELD
4	NOT USED
5	SINGLE OUTSIDE DRIVE EC (+)
6	OUTSIDE TEMPERATURE (+)
7	OUTSIDE TEMPERATURE (-)
8	VEHICLE GROUND
9	REVERSE INPUT (ACTIVE HIGH)
10	NOT USED
11	ONSTAR KEYPAD OUTPUT
12	ONSTAR KEYPAD POWER
13	IGNITION (RUN ONLY LINE)
14	ONSTAR LED GREEN
15	ONSTAR LED RED
16	SINGLE OUTSIDE DRIVE (-)

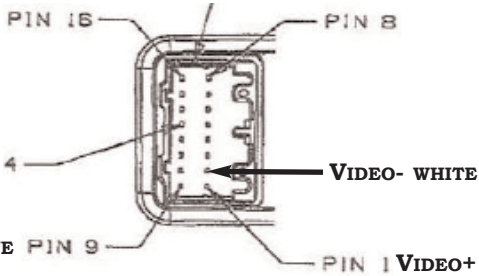

REVERSE BLUE PIN 9 PIN 1 VIDEO+ YELLOW

2. INSERT THE VEHICLE MONITOR CONNECTOR INTO NEW INSTALLED REARSIGHT MIRROR MONITOR. ROUTE THE MIRROR MONITOR HARNESS AND EXTENSION HARNESS TO TO REAR OF VEHICLE. FIGURE 3Be SURE HARNESS ARE ROUTED WHERE WIRES CANNOT BE PINCHED OR BOUND.
3. CONNECT **BLACK** GROUND WIRE FROM MIRROR MONITOR INTERFACE HARNESS TO GROUND POINT OF VEHICLE. IF NEEDED, CONNECT THE **BLUE** REVERSE WIRE FROM MIRROR MONITOR INTERFACE HARNESS TO 12 VOLT BACK UP LIGHT CIRCUIT.



FIGURE 3

CAMERA INSTALLATION

1. THE **CAMERA ASSEMBLY** IS FITTED WITH A **SHROUD** WHICH ALLOWS MOUNTING TO THE **LICENSE PLATE BRACKET** AS SHOWN IN **FIGURE 4**, OR MOUNT IN LICENSE PLATE LIGHT TRIM AREA. **FIGURE 5**.
2. SEE **FORM #5086** FOR CONVERSION OF SHROUD FOR SHOWN DRILL MOUNT. **FIGURES 6-8**. DRILL A 1/4" PILOT HOLE AND THEN ENLARGE IT TO 1-1/16". CLEAN AND DE-BURR THE HOLE. YOU MUST CLEAN THE MOUNTING AREA THOROUGHLY WITH THE PROVIDED ALCOHOL PAD, LET DRY, THEN APPLY DIRECT PRESSURE FOR **30 SECONDS** TO ENSURE PROPER ADHESION.
2. USE THE **30FT CAMERA EXTENSION HARNESS** TO CONNECT THE MIRROR MONITOR TO THE CAMERA. ROUTE THE EXTENSION HARNESS WITH EXISTING WIRING ALONG THE VEHICLE.

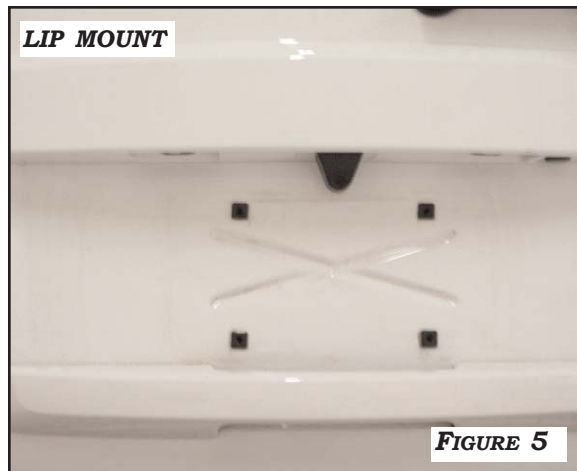

TESTING AND REASSEMBLY

TESTING

1. RECONNECT NEGATIVE BATTERY CABLE AND TORQUE TO **3 FT LBS.** RE-ENTER ANY THEFT DETERRENT INFORMATION, IF APPLICABLE.
2. TURN THE IGNITION SWITCH **ON**. PUT THE VEHICLE IN REVERSE. VERIFY THAT THE REARSIGHT MIRROR IS ON AND THAT THE CAMERA'S PICTURE APPEARS.
3. IF THERE IS NO PICTURE, VERIFY ALL CONNECTIONS ARE SECURE.

REASSEMBLY

1. REINSTALL ALL TRIM PIECES TAKING SPECIAL CARE TO ENSURE HARNESES AND WIRING CONNECTIONS ARE PROPERLY SECURED.
2. BE SURE HARNESS IS NOT PINCHED OR BOUND BY TRIM PIECES.
3. PLACE THE OWNER'S CARD IN THE GLOVE BOX.
4. RECONNECT ALL DISCONNECTED BULBS AND CHECK FOR FUNCTION.

TEMPLATES

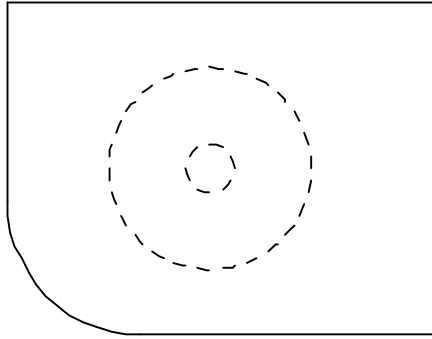

**CUT OUT THIS TEMPLATE. USE
CENTER HOLE FOR PILOT. FINISHED
HOLE SIZE SHOULD BE 1-1/16"**